

**How to purchase a data plan?**



**如何购买网络配套?**

**Bagaimana untuk membeli  
pelan internet?**



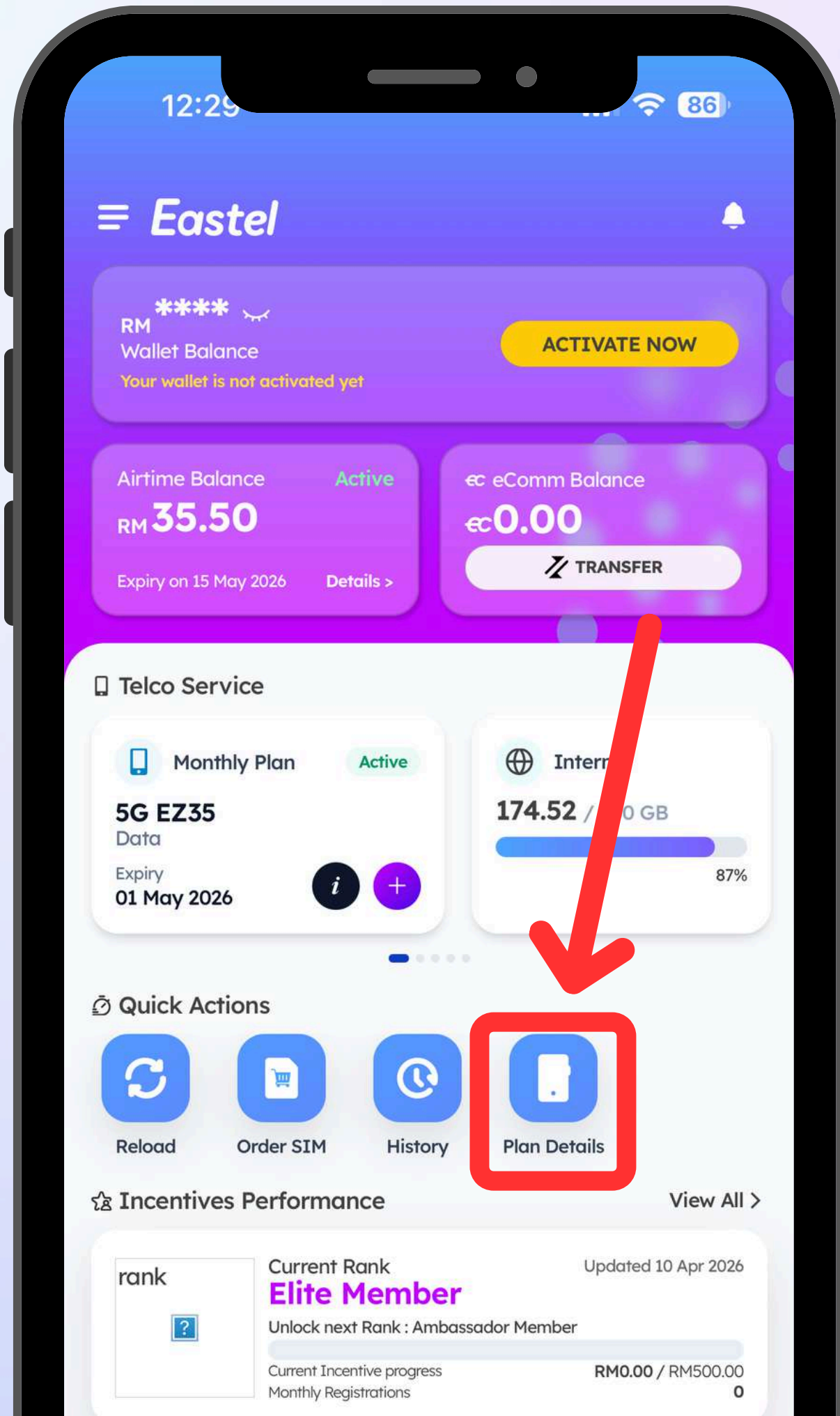

## Step 1

Click “Plan Details” to proceed to the purchase page

点击「Plan Details」进入购买页面

Klik “Plan Details” untuk ke halaman pembelian

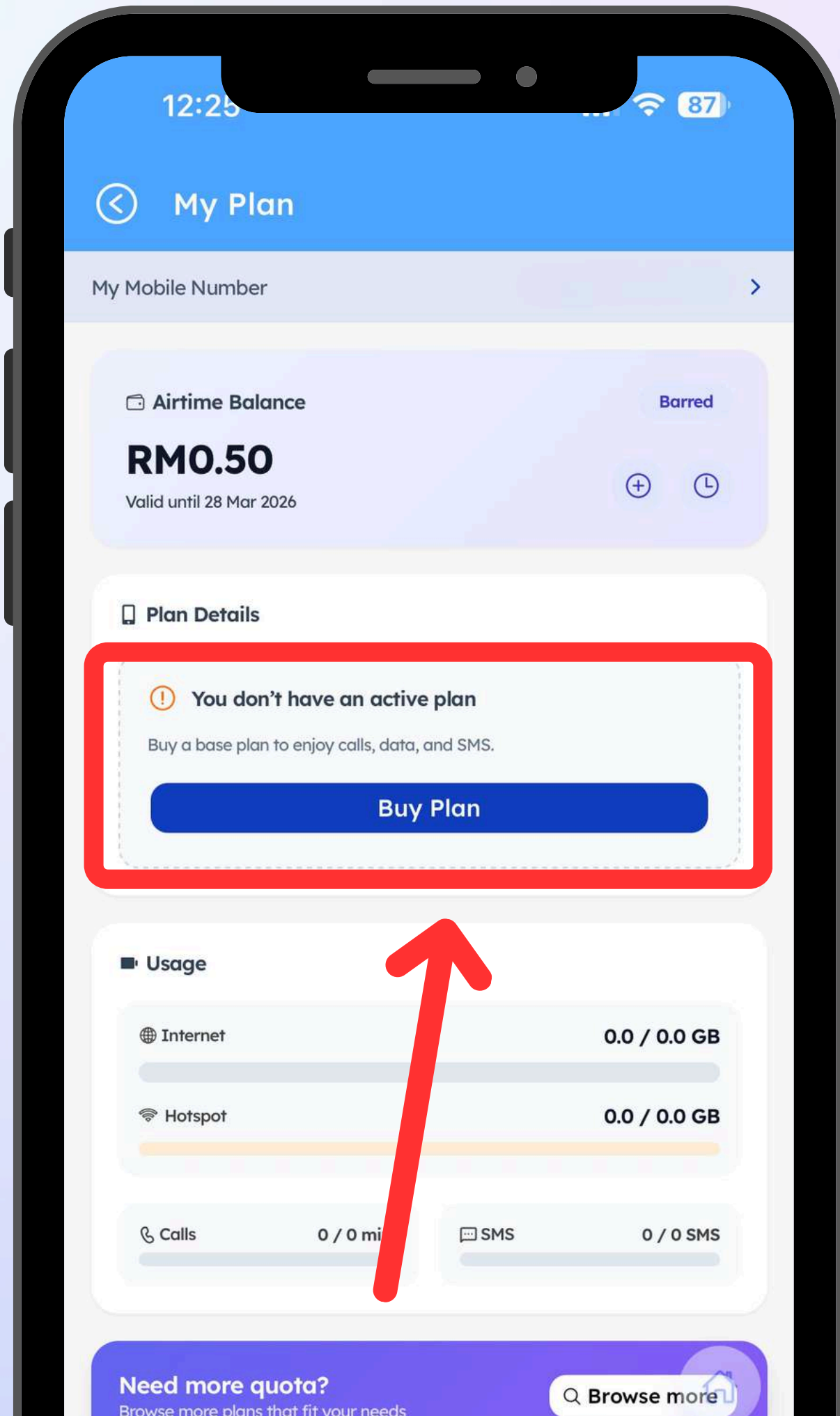

**Step 2**

**Tap “Buy Plan” to proceed**

**点击「Buy Plan」**

**Klik “Buy Plan” untuk  
meneruskan pembelian**

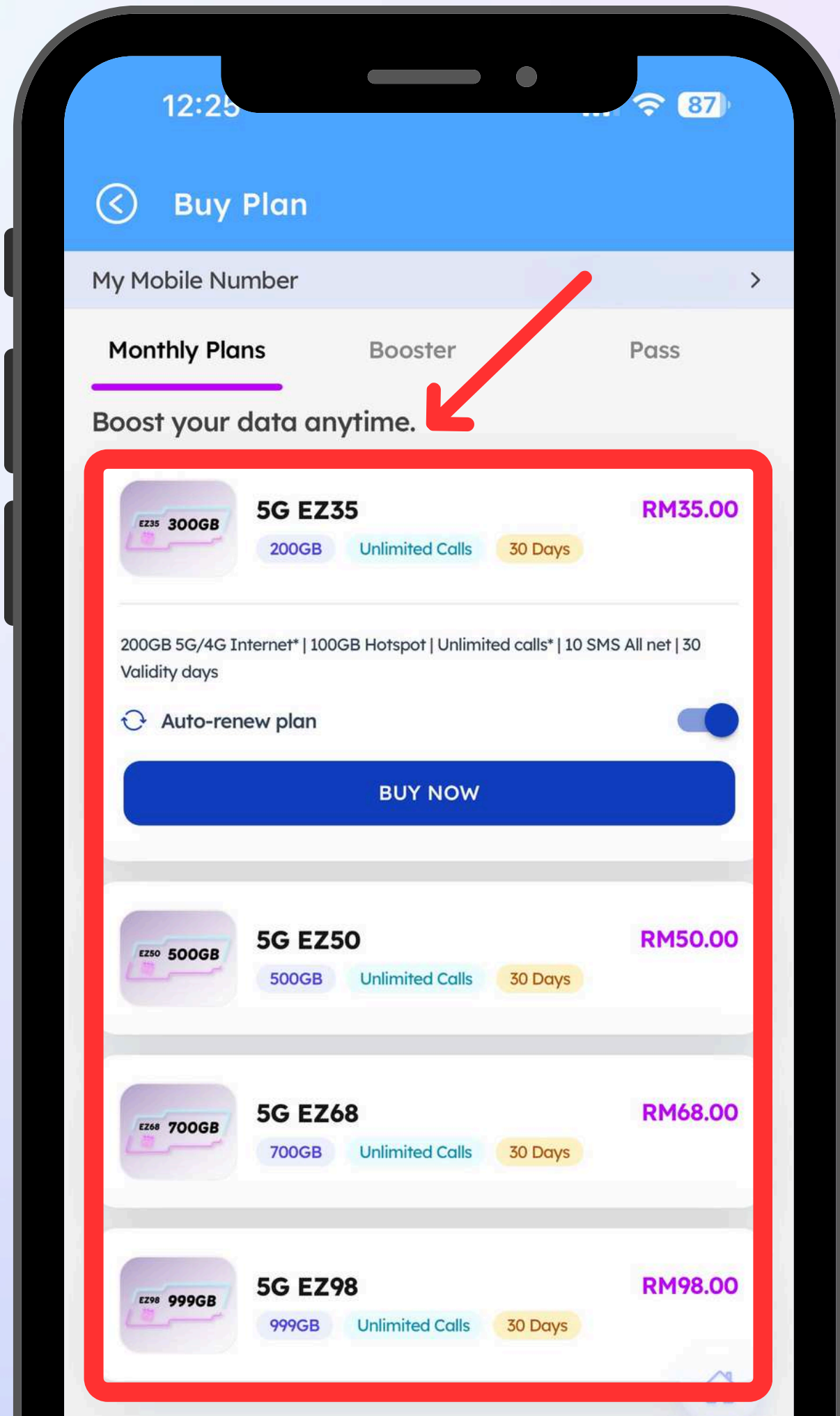

## Step 3

**Choose the data plan you want to purchase**

**选择想要购买的网络配套**

**Pilih pelan internet yang ingin dibeli**

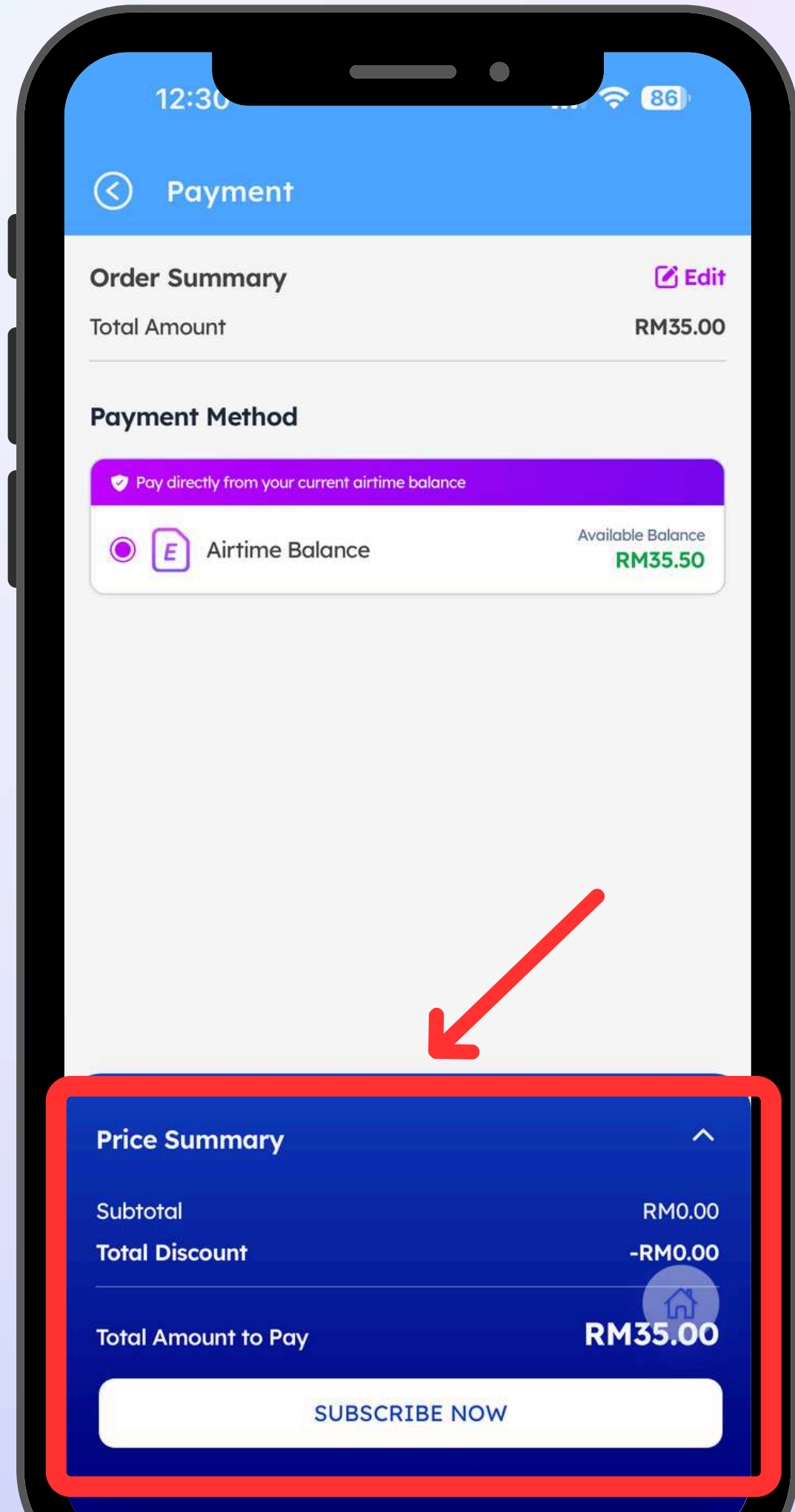

**Step 4**

**Click “SUBSCRIBE NOW”**

**点击「SUBSCRIBE NOW」**

**Klik “SUBSCRIBE NOW”**

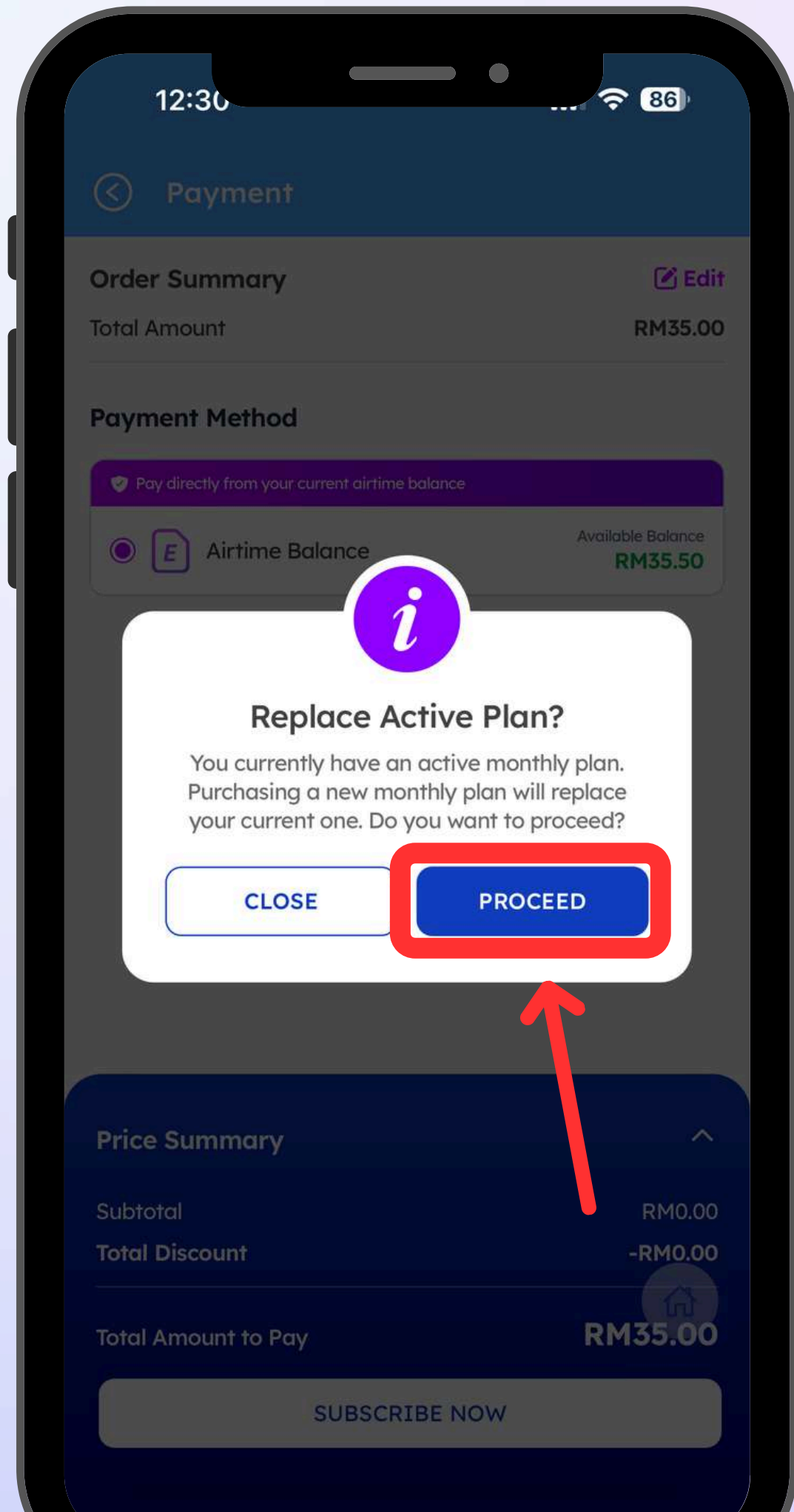

## Step 5

Tap “PROCEED” to continue

点击「PROCEED」继续操作

Klik “PROCEED” untuk teruskan

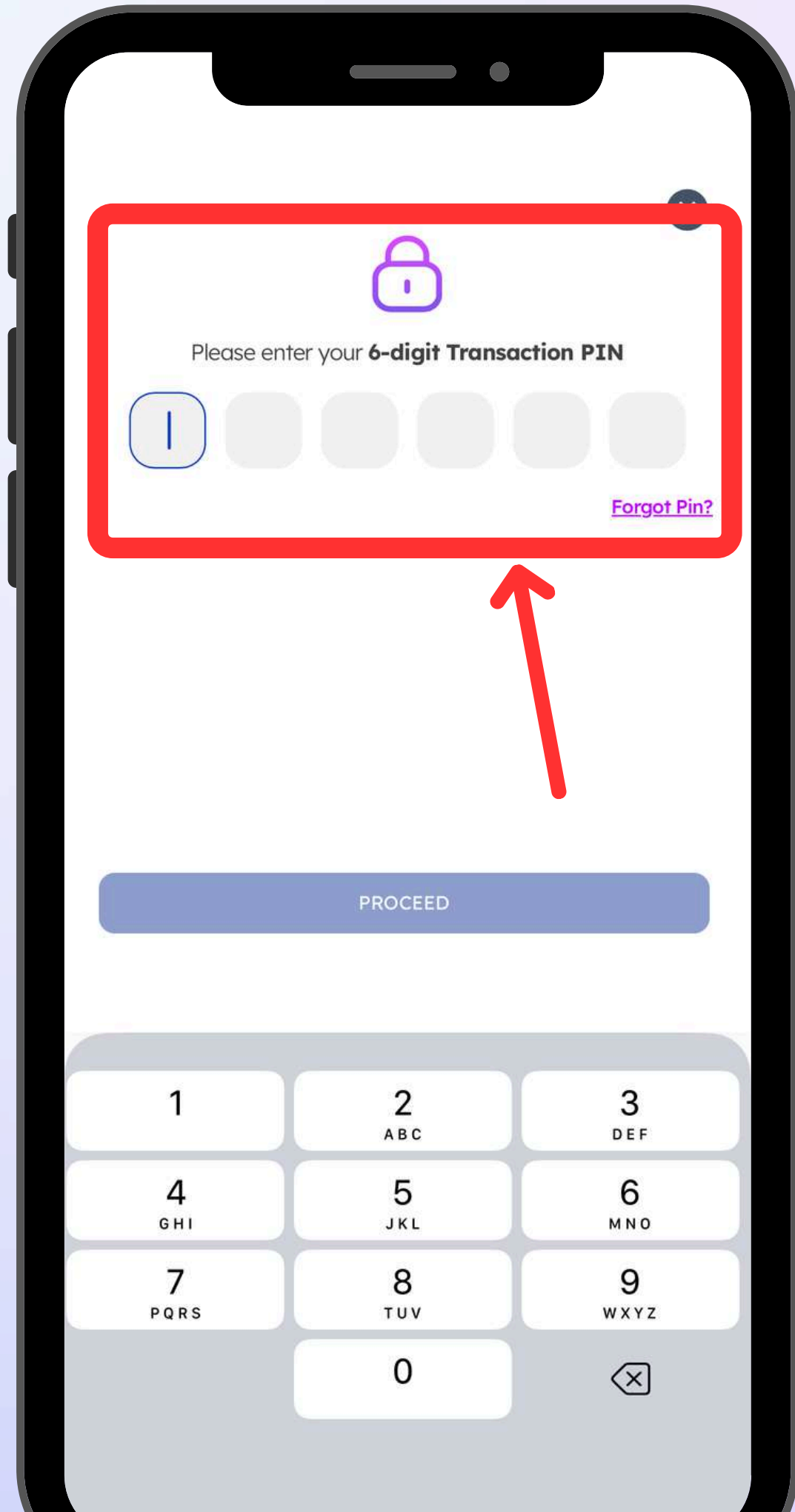

**Step 6**

**Enter your PIN**

**输入您设置的 PIN 码**

**Masukkan kod PIN anda**

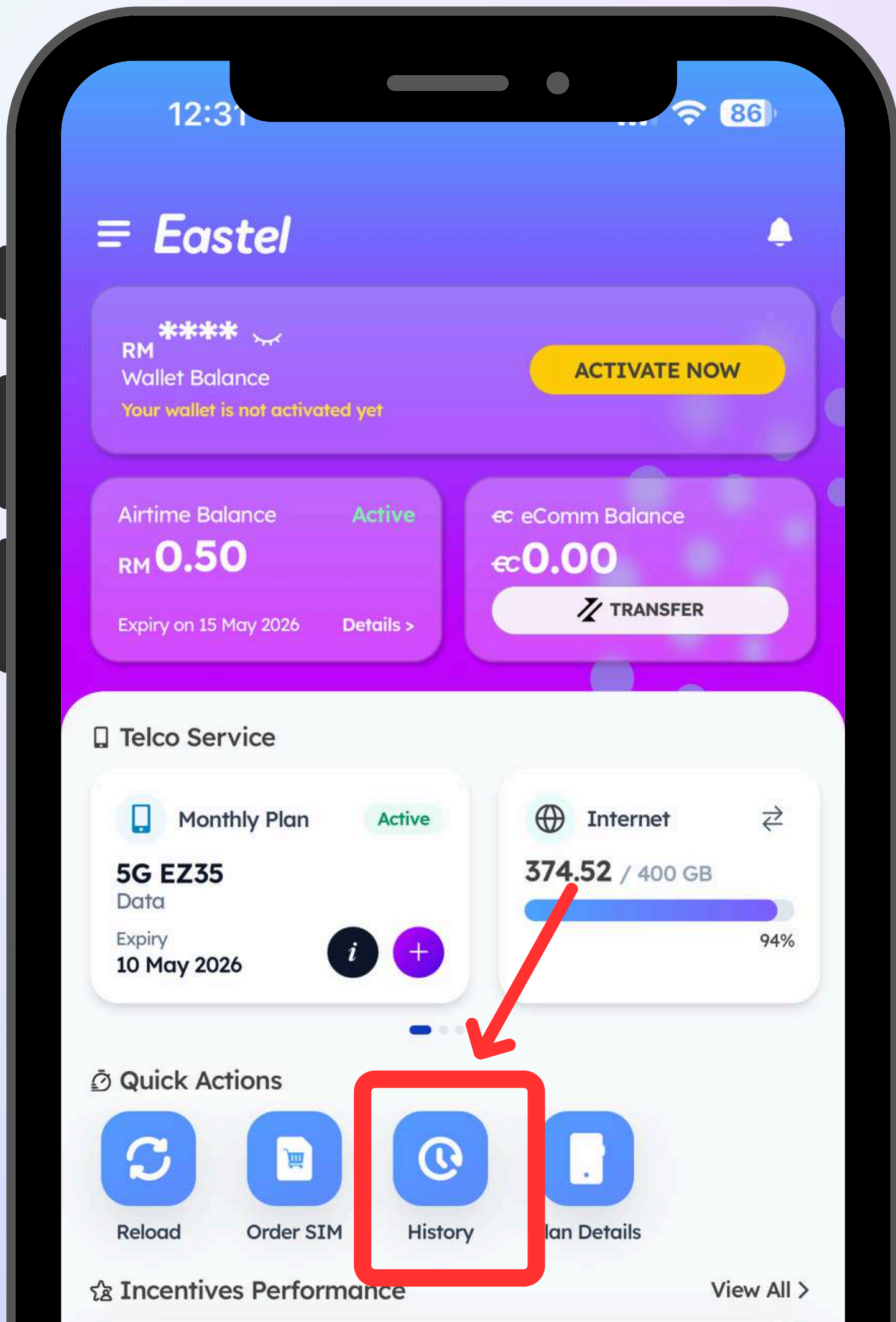

## Step 7

**Purchase successful! Tap “History” to view your records**

**购买成功！您可以点击「History」查看记录**

**Pembelian berjaya! Klik “History” untuk melihat rekod anda**

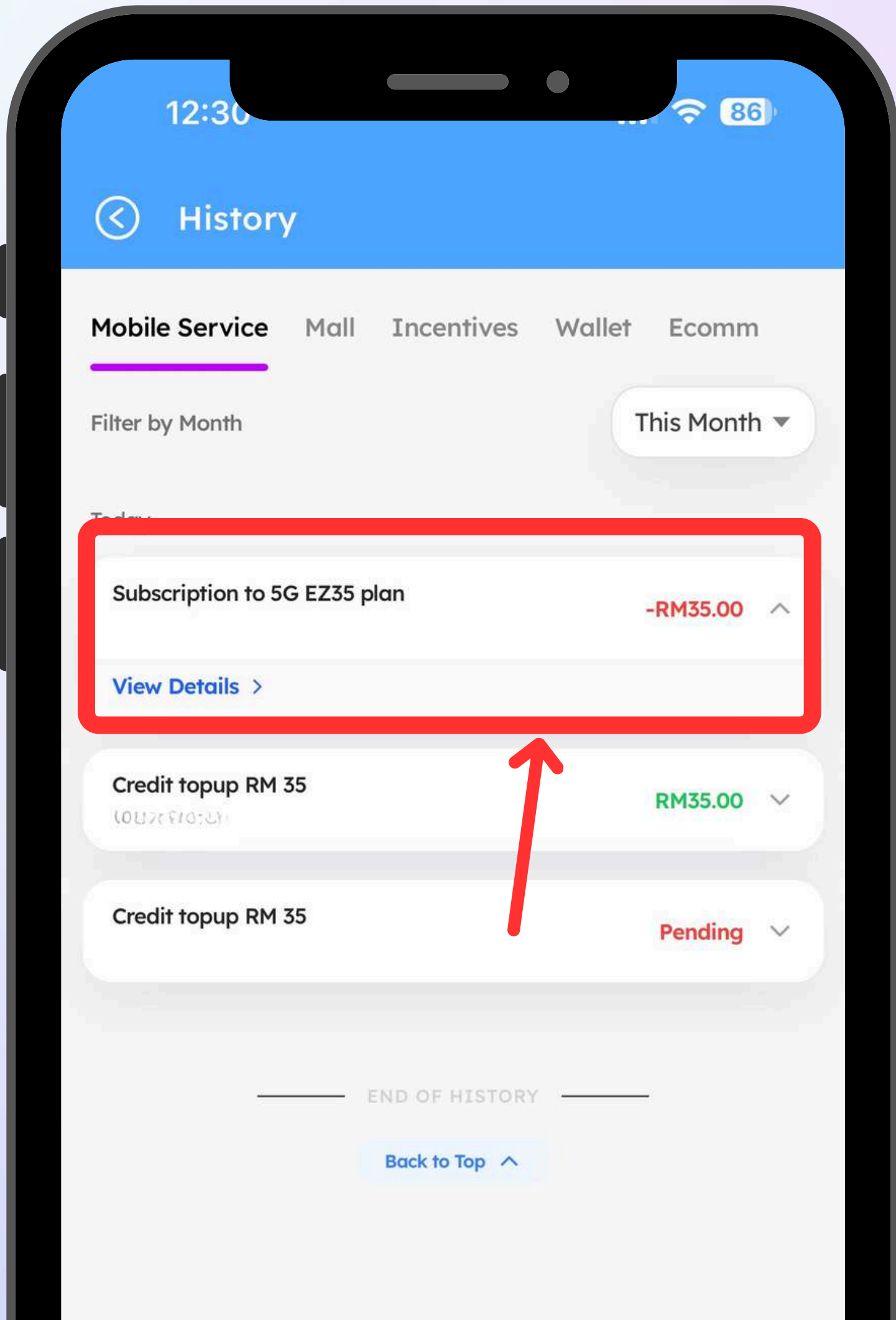

**Step 8**

**View history**

**查看购买记录**

**Lihat sejarah**



先注册，先赚钱。  
天天赚，月月赚，年年赚！

**Register Today, Start Earning Right Away.  
Earn Every Day, Every Month, Every Year!  
Daftar Hari Ini, Terus Mula Jana Pendapatan.  
Jana Setiap Hari, Setiap Bulan, Sepanjang Tahun!**

A registration card with a purple border. At the top left is a WhatsApp icon. To its right is the phone number "011-7621 5820". Below the number is a QR code icon and the text "UPLINE QR CODE". Underneath is the instruction "Ask your new member to scan this code during registration." In the center is a large QR code. Below the QR code is the text "UPLINE ID" and "E-0000156". At the bottom is the instruction "If scanning is not possible, the new member can enter this ID manually."



 **011-7621 5820**  
**EASTEL**

Contact us for Appointment.  
Sila hubungi kami untuk menetapkan temujanji.  
如需预约会面，请与我们联系。